



# offerings



Series/Style: ProLine  
Product: Fixed/Active In-Swing Hinge Door  
Color/Finish: Natural finish interior  
Grille: Wood interior-removable  
Hardware: Standard Brass

Series/Style: ProLine  
Product: Left-Hand Hinged Casement  
Color/Finish: Natural finish interior  
Grille: Wood interior-removable  
Hardware: Standard Champagne



Series/Style: ProLine  
Product: Double-Hung Window  
Color/Finish: Stained finish interior  
Grille: Wood interior-removable  
Hardware: Standard Champagne



Series/Style: ProLine  
Product: OX Sliding Patio Door  
Color/Finish: Natural finish interior  
Grille: Wood interior-removable  
Hardware: Standard Champagne



## about us

Pella Corporation is an innovative leader in creating a better view for homes and businesses by designing, testing, and manufacturing quality windows and doors. As a family-owned and professionally managed privately-held company, Pella is known for its 84-year history of innovation, making outstanding products, providing quality service and delivering on customer satisfaction. Headquartered in Pella, Iowa, the company provides careers for about 8,600 team members and is committed to incorporating new technologies, increasing productivity, and practicing environmental stewardship.

Few things enhance your home more than windows and doors. They fill your home with natural light. They help keep you comfortable in any kind of weather. And they're a stunning focal point that guests notice — inside your home and out.

Pella windows and doors do all this and more — their purposeful innovations also improve the quality of your life. Imagine spending less time dusting blinds. Picture rolling your window screens away, and out of sight, whenever you want. And that's just the start. It's simple, really.

**At Pella, we're not just building  
beautiful windows and doors.  
We're creating a better view.**

RECOGNIZED THREE YEARS IN A ROW



"Highest in Customer Satisfaction  
among Window and Door  
Manufacturers, Three Years in a Row"\*

\* Pella received the highest numerical score among window and door manufacturers in the proprietary J.D. Power and Associates 2007–2009 Windows and Patio Doors Satisfaction Studies™, 2009 study based on responses from 2,856 consumers measuring 8 brands and measures opinions of consumers who purchased new windows or patio doors in the previous 12 months. Proprietary study results are based on experiences and perceptions of consumers surveyed in March – April 2009. Your experiences may vary. Visit [jdpower.com](http://jdpower.com).



1-800-374-4758

[www.pella.com](http://www.pella.com)



**excel**  
HOMES



## PROLINE® DOUBLE-HUNG WINDOWS

excel  
HOMES

upgrade

Pella ProLine® is a beautiful collection of windows with our most popular choices — including a wide range of standard sizes, shapes, and styles. It also offers great features like prefinished white interiors and grille-between-the-glass. Best of all, you get the satisfaction of owning Pella craftsmanship. All this at a competitive price.

### UNIQUE PROLINE FEATURES:

- Pella quality with the most popular features and options at a competitive price. ProLine windows offer many of the features found on our premium brands.
- Eight EnduraClad® exterior colors to choose from to complement your home's exterior. Available in three standard colors (white, tan, and brown) as well as five feature colors.
- A wide range of standard sizes to fit most any opening in your home. Create a custom look at a standard price with factory-assembled window combinations.
- Available with your choice of two distinctive grille types including wood grilles and grilles-between-the-glass for the look of divided-light windowpanes. Mix and match to create a style all your own.



Series/Style: ProLine  
Product: Double-Hung Window  
Color/Finish: Natural finish interior  
Hardware: Standard Champagne

### ENERGY EFFICIENCY

ProLine® venting windows are factory-tested for air infiltration. If they don't meet our rigorous standards, they don't ship. Because of our commitment to quality, consumer satisfaction and continuous improvement, you can rest assured Pella windows will perform for years to come.

All ProLine windows with Pella's energy-saving Advanced Low-E insulation glass



meet or exceed 2010 ENERGY STAR® guidelines and requirements in all 50 states.\* You'll enjoy lower heating and cooling bills and a more comfortable home all year-round.

\* Some Pella products may not meet ENERGY STAR guidelines in Canada. For more information, contact your local Pella representative or go to [energystar.gc.ca](http://energystar.gc.ca).

Series/Style: ProLine  
Product: Double-Hung Window  
Color/Finish: Prefinished white interior  
Grille: Wood, prefinished white interior-removable  
Hardware: Standard White



ProLine®  
*Basic done beautifully.®*

excel  
HOMES





PROLINE®  
SLIDING DOORS

excel  
HOMES

upgrade

When room is tight, sliding patio doors are just right. They don't swing, so they require less floor space than a hinged door. From kitchen to bedroom, and from traditional to contemporary, they're perfect for your home's style, too. Pella ProLine® is a beautiful collection of patio doors with our most popular choices — including a wide range of standard sizes, shapes, and styles.



Series/Style: ProLine  
Product: OX Sliding Patio Door  
Color/Finish: Natural finish interior  
Grille: Wood interior-removable  
Hardware: Standard Champagne

### WHY CHOOSE A PELLA PROLINE SLIDING PATIO DOOR?

- Exterior venting panel — when the wind blows against it, it creates a tighter seal.
- Exterior handle is corrosion-resistant and finished to match the exterior EnduraClad® color.
- Convenient thumblock allows easy one-hand operation. A single-point locking system adds security. A keylock for the exterior is also an available option for ProLine sliding patio doors.
- Wood interiors are available in unfinished pine or prefinished. These are options that save time and finishing costs.
- Oak threshold with clear-coat finish delivers durability, thermal insulating value and the beauty of wood.
- Heavy-duty ball-bearing door roller system operates smoothly and easily on a stainless-steel track.
- Dual extruded, flexible weatherstripping at head, jamb and sill interlocks with vertical panel to keep air and water outside.

### ENERGY EFFICIENCY

ProLine® sliding patio doors are factory-tested for air infiltration. If they don't meet our rigorous standards, they don't ship. Because of our commitment to quality, consumer satisfaction and continuous improvement, you can rest assured Pella windows will perform for years to come.

All ProLine windows with Pella's energy-saving Advanced Low-E insulation glass meet or exceed 2010 ENERGY STAR® guidelines and requirements in all 50 states.\* You'll enjoy lower heating and cooling bills and a more comfortable home all year-round.



\* Some Pella products may not meet ENERGY STAR guidelines in Canada. For more information, contact your local Pella representative or go to [energystar.gc.ca](http://energystar.gc.ca).



Series/Style: ProLine  
Product: OX Sliding Patio Doors  
Color/Finish: Prefinished white interior  
Grille: Wood, prefinished white interior-removable  
Hardware: Standard White

ProLine®  
*Basic done beautifully.®*

excel  
HOMES



**IMPERVIA® FIBERGLASS  
WINDOWS & DOORS**

**excel**  
HOMES

**upgrade**

Pella Impervia® products are incredibly energy efficient and low-maintenance. Made from a patented fiberglass composite called Duracast®, these products can take almost anything — including extreme weather and sea air. And they have the quality look of painted wood. Pella Impervia. Just another way Pella gives you everything you expect from a window or patio door — and more.

### WHY CHOOSE PELLA® IMPERVIA® WINDOWS AND PATIO DOORS?

- Pella Impervia fiberglass composite windows and patio doors are prefinished to closely resemble quality painted wood — they don't have the shiny look of vinyl. Long-lasting factory powder-coat finish stays looking great for years with little care.
- Grilles-between-the-glass are easy to care for and easier to love. They're available in a variety of patterns to complement your home.
- Made from Duracast® — with the durability to be virtually impervious to all weather conditions. It won't expand and warp in the summer or shrink and turn brittle in the winter.
- More style — three standard colors (white, tan and brown) and several hardware finish options are available.
- Energy-efficient to save money. Pella Impervia products with Pella's energy-saving SunDefense™ IG with argon insulation glass and foam insulation will meet or exceed 2010 ENERGY STAR® guidelines in all 50 states.\*

\* Some Pella products may not meet ENERGY STAR guidelines in Canada. For more information, contact your local Pella representative or go to [energystar.gc.ca](http://energystar.gc.ca).

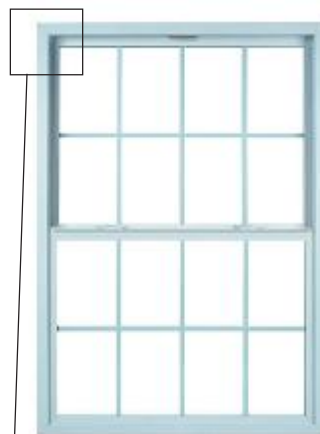

Series/Style: Impervia  
Product: Double-Hung Window  
Color/Finish: White  
Grille: White grilles-between-the-glass (GBG)  
Hardware: Standard White

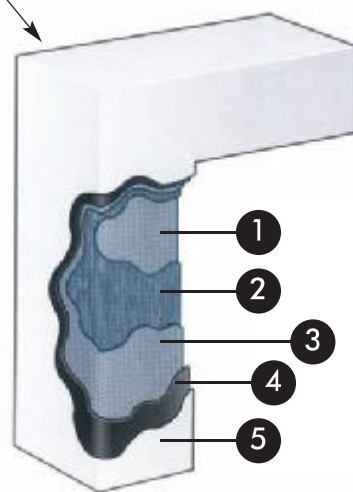

### **Duracast® — Pella's Patented Fiberglass Composite**

1. Patented Interlocking Mat
2. Structural Core
3. Patented Interlocking Mat
4. Heat-Set Resin
5. Baked-On Finish



Series/Style: Impervia  
Product: Double-Hung Window  
Color/Finish: White  
Grille: White grilles-between-the-glass (GBG)  
Hardware: Standard White

**Impervia®**  
*Advanced Alternative. Lasting Value.®*

PALPLPW01PWLO9

**excel**  
HOMES